

Vista isometrica

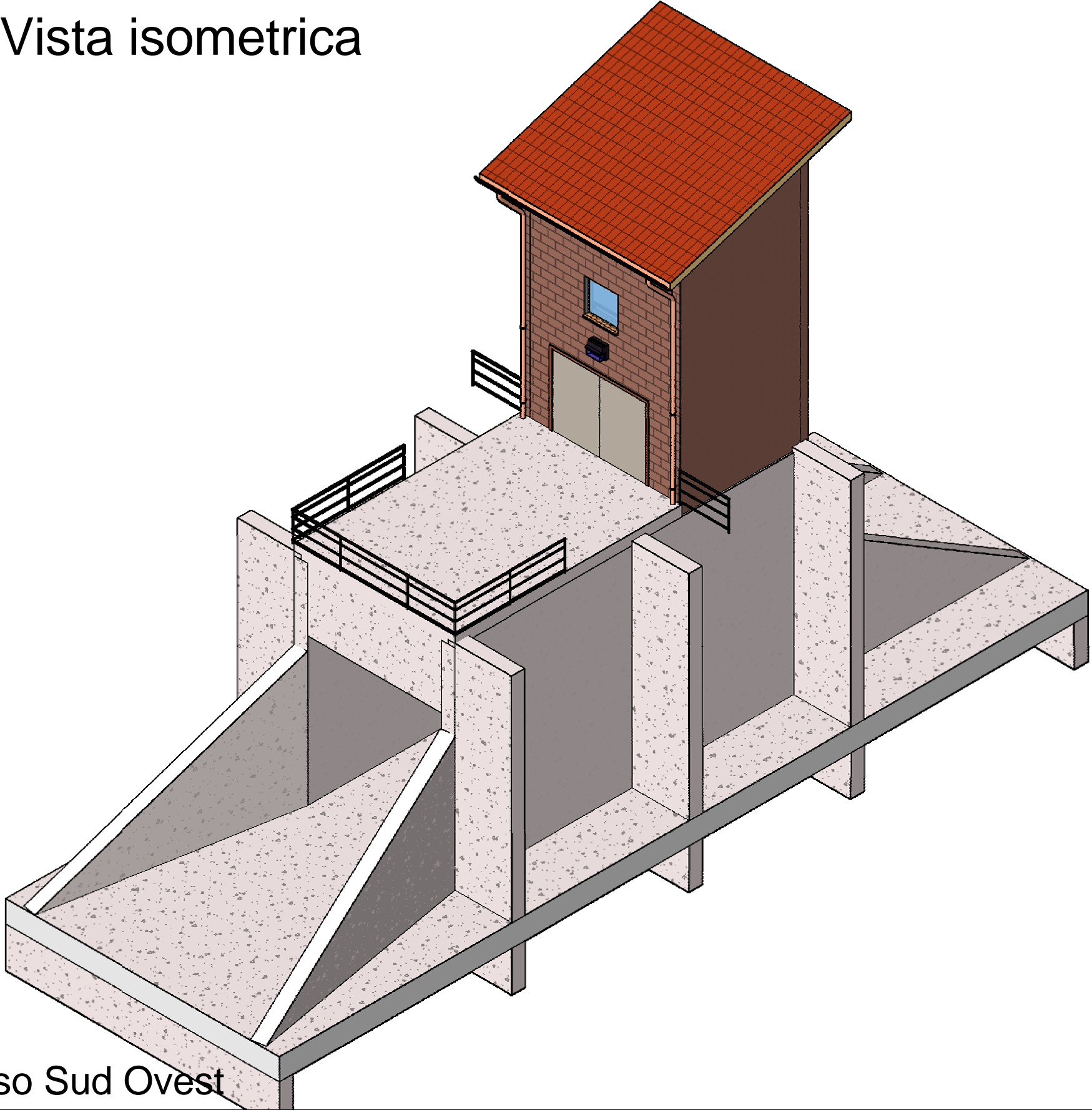

2 Iso Sud Ovest

Vista isometrica

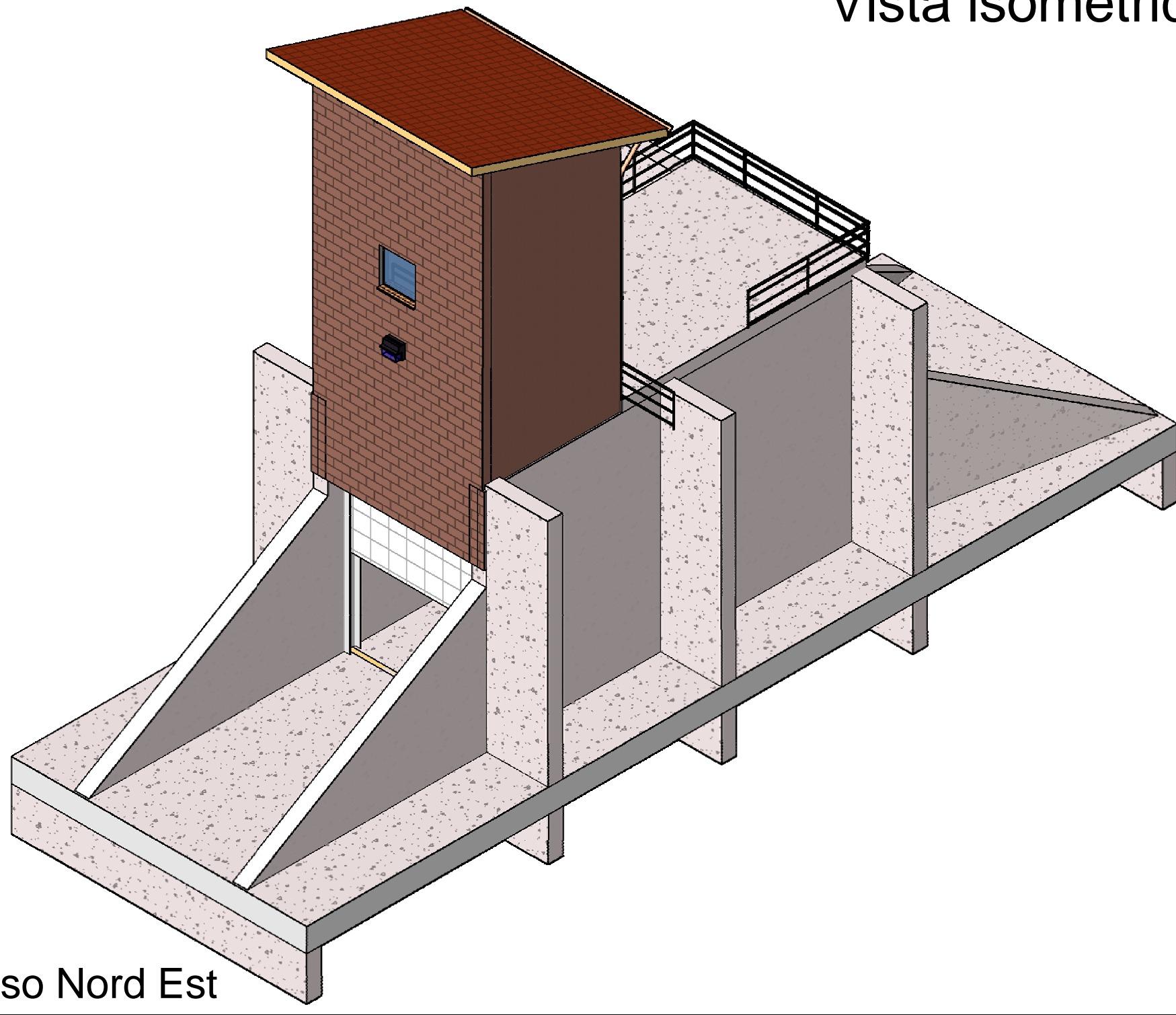

1 Iso Nord Est



4 render con foto
1 : 10

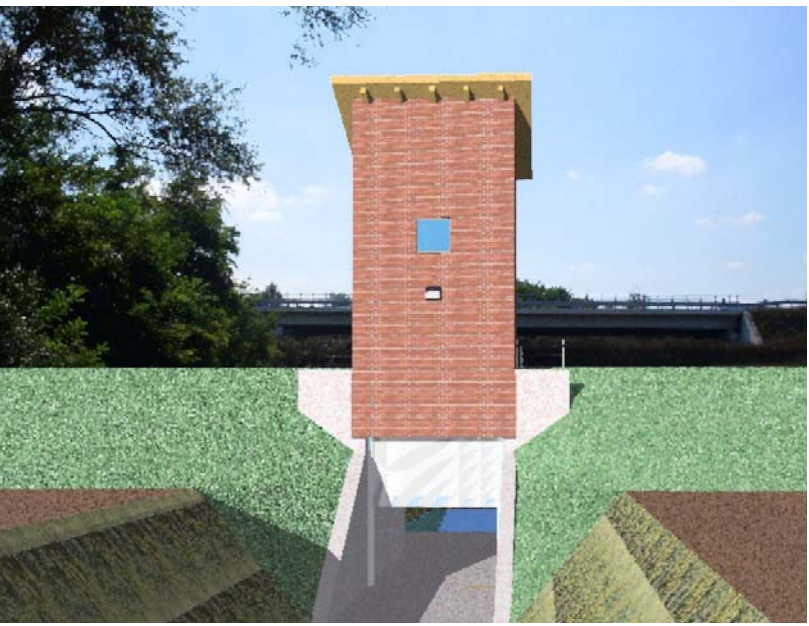

5 render con foto 2
1 : 10

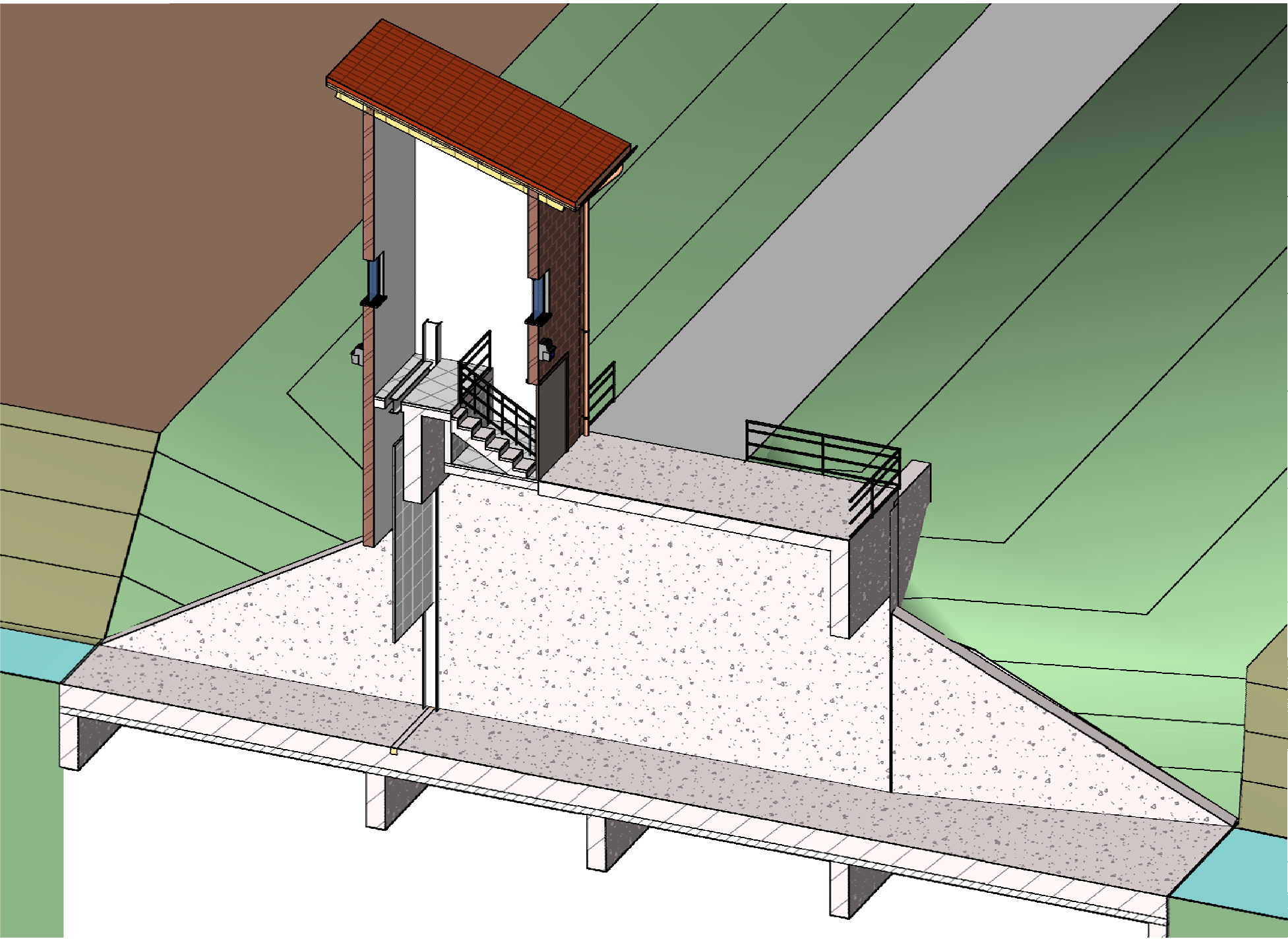

3 Spaccato



6 render da argine
1 : 10

AIPO
Agenzia Interregionale per il Fiume Po

NODO DI ALESSANDRIA
PROGETTO ESECUTIVO

Perizia n° 3244/E data: 21/6/2010

Chiavica canale Carlo Alberto
Tavola 9-A-1 architettonico

Tridimensionali
Scala 1 : 10

PROGETTISTI:
Dr. Ing. Gianluca ZANICHELLI
Dr. Ing. Federica PELLEGRINI

Collaboratori:
Geom. Giuliano BENNATI
Geom. Fulvio FOGLIACCO
Geom. Paola PRUZZI
Geom. Fabrizio VARDARO
Geom. Calogero MAGRO

Tavola n. 9-A.3